

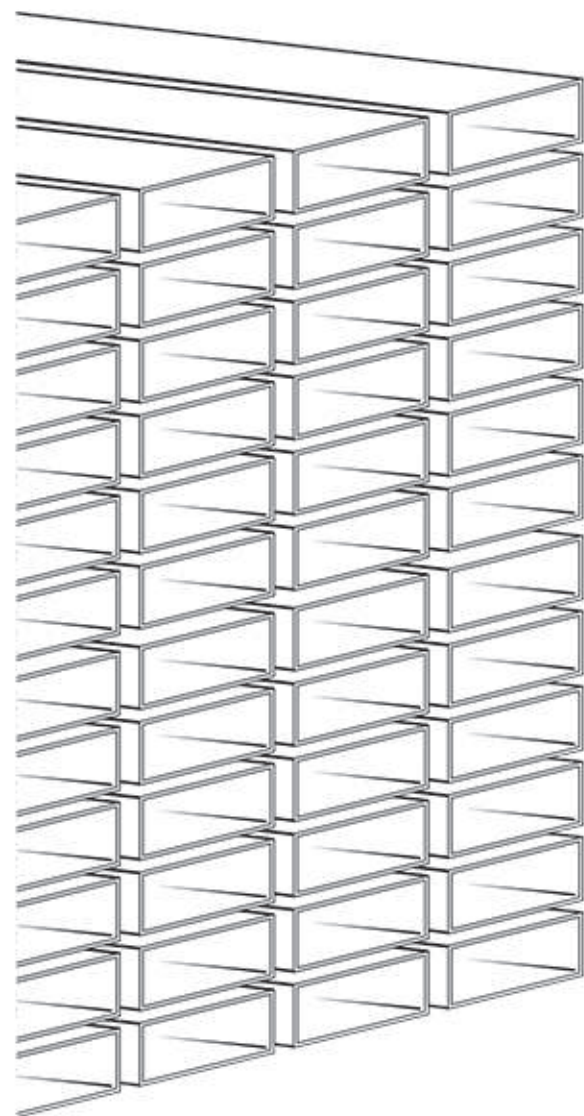

RECTANGULAR PTR



| RECTANGULAR PTR | | | | | | |
|-----------------|-----------------|-----------|---------|----------------|--------|-----------------|
| DIMENSIONS | NOMINAL CALIBER | THICKNESS | | ASSUMED WEIGHT | LENGTH | PIECES PER PACK |
| Inches | | Inches | mm | kg/m | Meters | |
| 2 X 1 | 18 | 0.0478 | 1.21 | 1.44 | 6 | 56 |
| | 14 | 0.0747 | 1.90 | 2.24 | 6 | 56 |
| | 11 | 0.1196 | 3.04 | 3.16 | 6 | 56 |
| 2.5 X 1.25 | 18 | 0.0478 | 1.21 | 1.81 | 6 | 54 |
| 2.5 X 1.5 | 18 | 0.0478 | 1.21 | 1.94 | 6 | 48 |
| | 14 | 0.0747 | 1.90 | 3.03 | 6 | 48 |
| 3 X 1.5 | 18 | 0.0478 | 1.21 | 1.94 | 6 | 49 |
| | 14 | 0.0747 | 1.90 | 3.03 | 6 | 49 |
| 3 X 2 | 14 | 0.0747 | 1.90 | 3.82 | 6 | 35 |
| | 11 | 0.1196 | 3.04 | 5.59 | 6 | 28 |
| | 10 | 0.1345 | 3.42 | 6.22 | 6 | 28 |
| | 3/16" | 0.1875 | 4.76 | 8.33 | 6.1 | 28 |
| 4 X 1.5 | 18 | 0.0478 | 1.21 | 2.68 | 6 | 35 |
| | 14 | 0.0747 | 1.90 | 4.22 | 6 | 35 |
| 4 X 2 | 14 | 0.0747 | 1.90 | 4.61 | 6 | 30 |
| | 11 | 0.1196 | 3.04 | 6.81 | 6 | 25 |
| | 10 | 0.1345 | 3.42 | 7.59 | 6 | 25 |
| | 9 | 0.1495 | 3.80 | 8.26 | | 20 |
| | 3/16" | 0.1875 | 4.76 | 10.24 | 6.1 | 20 |
| 4 X 3 | 14 | 0.0747 | 1.89738 | 5.4 | 6 | 20 |
| | 11 | 0.1196 | 3.03784 | 8.02 | 6 | 16 |
| | 9 | 0.1495 | 3.7973 | 9.75 | 6 | 16 |
| | 3/16" | 0.188 | 4.7752 | 12.14 | 6.1 | 16 |
| 6 X 4 | 11 | 0.1195 | 3.0353 | 11.61 | 6 | 16 |
| | 3/16" | 0.1875 | 4.7625 | 17.85 | 6.1 | 16 |

www.magnacero.com

ventas@magnacero.com

01 (477) 194 18 00